

## LRA-DCTX Door/Window Magnetic Contact User Manual

### Parts and Function

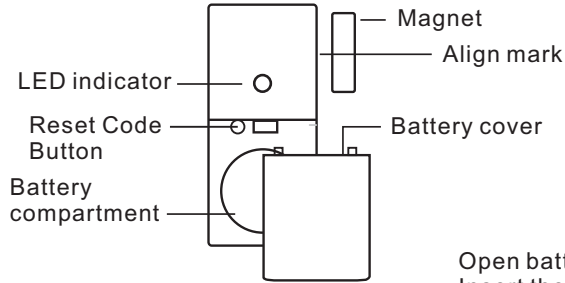

### Battery Installation

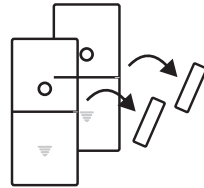
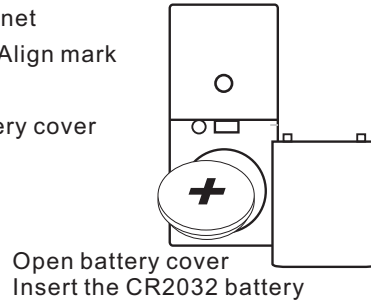

### Operation

When the magnet moves away from the sensor unit, the sensor send out a signal to the receiver (chime).

### CODE MATCHING & TUNE SELECTION

Below is an overview of how to pair this transmitter with the LRA-DCRX & LRA-DCRXA receivers. Pairing with the LRA-DCRXS is slightly different. If pairing this transmitter with the LRA-DCRXS Plug-inStrobe Receiver, please reference that user manual. To pair with the LRA-DCRX & LRA-DCRXA use the instructions below.

- Step1: Insert the battery into the transmitter to be used (door / window contact)
- Step 2: Insert the batteries into the receiver (chime unit) or plug-in the chime unit
- Step 3: Enter pairing mode for the receiver (chime unit): Press & hold the ● zone selector button for 3 seconds. The LED in zone #1 will flash.
- Step 4: Press the ● zone selector button again to move to the zone you wish to pair with. Press the 🎵 melody selector button to scroll through the melodies. Once you hear a melody you prefer, do not press any button as the melody is set for that zone.
- Step 5: Once the zone & melody are selected, trigger the pusher once to pair. If successful, the receiver (chime unit) will generate two short tones. Press the ● zone selector button to exit the pairing mode, the system is now ready to use. To stop the Chime while the receiver (chime unit) is alerting press the reset button located on back, upper right-hand corner.

### Mounting

Install a CR2032 battery into the battery compartment. Stick the double sided tape on the back of the alarm unit, then remove the back paper of the double sided tape. Stick the alarm unit to the window/door frame and the magnet unit to the door/window by the side of the alarm unit..

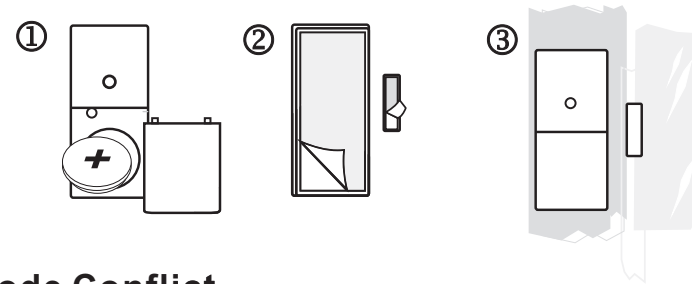

### Code Conflict

If the transmitter coding is the same as another transmitter you must change the code. When you have changed the code re-pair the transmitter is needed.

Press and hold 3 seconds to reset the code using a pen.

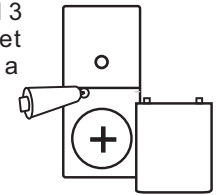

### TECHNICAL SUPPORT

If you need assistance with the operation of this product, please contact us. You can reach us by phone at 904-245-1184 from 8:00AM to 5:00PM Monday through Friday, EST. You may also reach us via email at [info@safeguardsupply.com](mailto:info@safeguardsupply.com)

### WARRANTY INFORMATION

The product you have purchased is guaranteed against defects in workmanship and materials for a period of one year from the date of purchase. Warranties implied by law are subject to the same time period limitation. For a detailed warranty policy, please visit our website by visiting: [www.safeguardsupply.com](http://www.safeguardsupply.com)

### FCC Statement:

This equipment has been tested and found to comply with the limits for a Class B digital device, pursuant to part 15 of the FCC Rules. These limits are designed to provide reasonable protection against harmful interference in a residential installation. This equipment generates, uses and can radiate radio frequency energy and, if not installed and used in accordance with the instructions, may cause harmful interference to radio communications. However, there is no guarantee that interference will not occur in a particular installation. If this equipment does cause harmful interference to radio or television reception, which can be determined by turning the equipment off and on, the user is encouraged to try to correct the interference by one or more of the following measures:

- \* Increase the separation between the equipment and receiver.
- \* Connect the equipment to an outlet on a circuit different from that to which the receiver is connected.

This device complies with part 15 of the FCC rules. Operation is subject to the following two conditions: (1) This device may not cause harmful interference, and (2) this device must accept any interference received, including interference that may cause undesired operation.

**Note: Modifications to this product will void the user's authority to operate this equipment.**

