

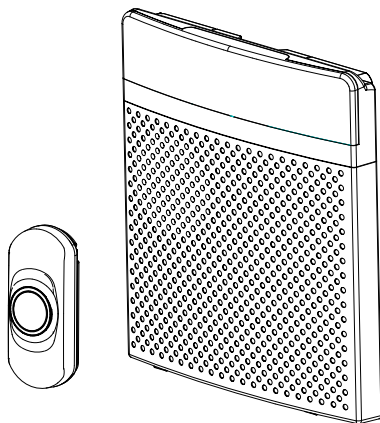

Phone: (904) 245-1184
 email: info@safeguardsupply.com
 2260 Moon Station Ct. NW #110 Kennesaw GA 30144

LRA-DCRXA + LRA-PBTXA Wireless Chime Receiver with Strobe Manual



THINGS TO KNOW PRIOR TO USE

- Each LRA-DCRXA (receiver) can pair with a total of four (4) wireless transmitters
- Once four (4) transmitters have been paired to a receiver, you cannot add an additional transmitter unless you delete a transmitter from the receiver
- There is no limit to the number of receivers you can pair with a transmitter
- The receiver is powered by 3 x c'-sized alkaline batteries or plug-in transformer (not included)

PRODUCT FEATURES & SPECIFICATIONS

- Wireless range from transmitter to receiver is up to 1,000 ft.(line of sight)
- Each receiver can pair with a total of two (2) transmitters
- Receiver has three (3) operating modes; a) sound only, b) strobe only & c) sound & strobe
- Assign one (1) of eighteen (18) available melodies to each transmitter
- Strobe has two flashing patterns; a) slow & b) fast
- Operating frequency: 868MHz
- Operating temperature: 32F to 104F
- Product dimensions: 2.5" L x 1.2" W x 4.72" H
- Product weight: .45 lbs

PARTS & FUNCTION

LRA-DCRXA Receiver

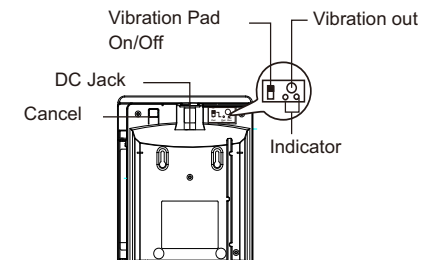
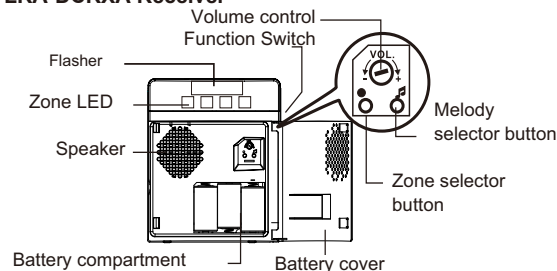

LRA-PBTXA Push Button

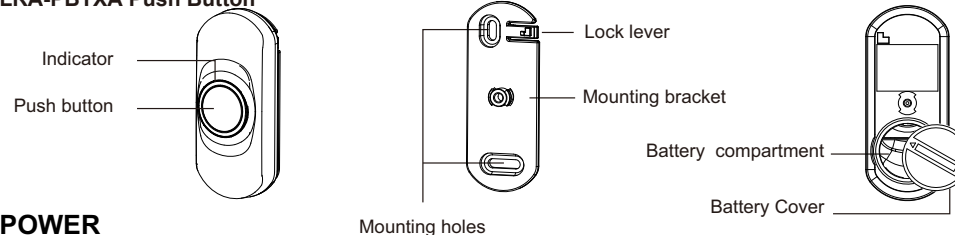

POWER

LRA-DCRXA Receiver

1. Flip to open the battery cover
2. insert 3 'C' size batteries
3. Close the battery cove

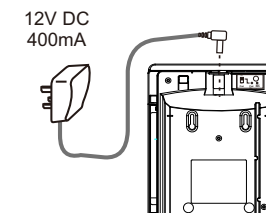
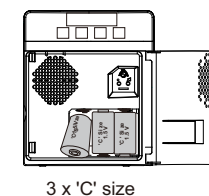

LRA-PBTXA Push Button

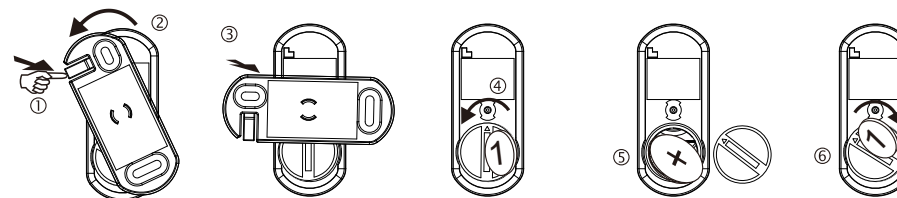

1. Use finger to unlock the lock lever
2. Rotate the mounting bracket 90 degrees and lift bracket from front of push button unit.
3. Remove the mounting bracket from the unit.
4. Rotate the Battery cover using a coin.
5. Insert a CR2032 battery to battery compartment provided.
6. Close the battery cover using a coin.

Installation

LRA-DCRXReceiver

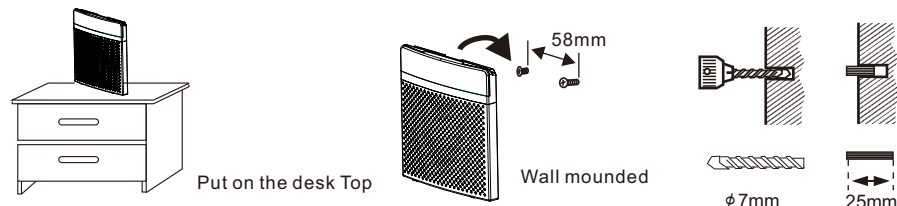

Push Button Mounting with screws

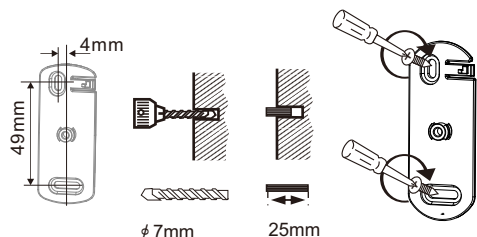

Requires an electric drill for holes to fix the wall bracket with the provided ram plug and screws.

Put the bell press to the bracket

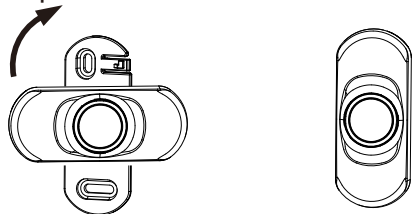

Put the push button into the bracket at a 90 degree angle. Rotate the push button clockwise until you feel it locked

Push Button Mounting with double-sided adhesive

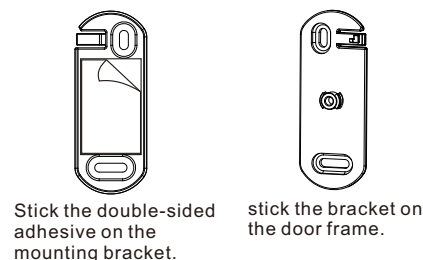

Stick the double-sided adhesive on the mounting bracket.

stick the bracket on the door frame.

CODE MATCHING & TUNE SELECTION

Step1: Insert the battery into the transmitter to be used (doorbell button)

Step 2: Insert the batteries into the receiver (chime unit).

Step 3: Enter pairing mode for the receiver (chime unit). Press & hold the ● zone selector button for 3 seconds. The LED in zone #1 will flash.

Step 4: Press the ● zone selector button again to move to the zone you wish to pair with. Press the 🎵 melody selector button to scroll through the melodies. Once you hear a melody you prefer, do not press any button as the melody is set for that zone.

Step 5: Once the zone & melody are selected, trigger the pusher once to pair. If successful, the receiver (chime unit) will generate two short tones. Press the ● zone selector button to exit the pairing mode, the system is now ready to use.

To stop the Chime while the receiver (chime unit) is alerting press the reset button located on back, upper right-hand corner.

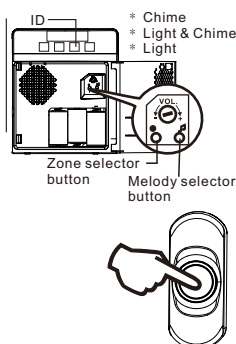

Delete the remote button on the chime memory

First, Press and hold the 'Learning' button for 3 seconds to enter the learning mode. Press the 'Learn' button to select the zone you want to delete. Press and hold both the 'Learning' and the 'Melody' button 3 seconds. The chime will generate a tone to indicate the remote on this zone has been deleted.

Change the melody/tone on desired zone

First, Press and hold the 'Learning' button for 3 seconds to enter the learning mode. Press the 'Learn' button to select the zone you want to change. Press the 'Melody' button to select the new melody/tone and then push the remote button. You will hear a tone to indicate the melody has been changed.

BATTERY LOW INDICATOR

If a zone LED light is blinking, it indicates that the battery is low for this transmitter. You must replace the battery as soon as possible. If the white flash at the top of the Chime blinks every 5 seconds, this indicates the receiver batteries are low. You must replace the batteries of the receiver.

Code Conflict

If the bell press coding is the same as another transmitter you must change the code.

When you have changed the code re-pair the telephone signaler.

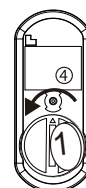

Open the battery cover

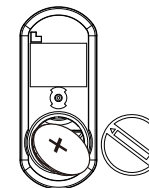

Take out the battery

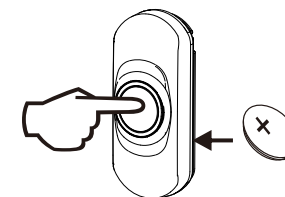

Press and hold the button, insert the battery whilst holding the button for 5 seconds. The LED will flash 5 times when a new code is generated

FCC Statement:

This equipment has been tested and found to comply with the limits for a Class B digital device, pursuant to part 15 of the FCC Rules. These limits are designed to provide reasonable protection against harmful interference in a residential installation. This equipment generates, uses and can radiate radio frequency energy and, if not installed and used in accordance with the instructions, may cause harmful interference to radio communications.

However, there is no guarantee that interference will not occur in a particular installation. If this equipment does cause harmful interference to radio or television reception, which can be determined by turning the equipment off and on, the user is encouraged to try to correct the interference by one or more of the following measures:

- * Reorient or relocate the receiving antenna.
- * Increase the separation between the equipment and receiver.
- * Connect the equipment to an outlet on a circuit different from that to which the receiver is connected.

This device complies with part 15 of the FCC rules. Operation is subject to the following two conditions: (1) This device may not cause harmful interference, and (2) this device must accept any interference received, including interference that may cause undesired operation.

Note: Modifications to this product will void the user's authority to operate this equipment.

