



SAFEGUARD SUPPLY CONTACT INFORMATION

Phone: (678) 214-4212 |email: info@safeguardsupply.com
 2260 Moon Station Ct. NW #110 | Kennesaw, GA 30144 USA

LRA-EX1000 & LRA-EXTX User Manual

LRA-EX1000 Kit Includes: LRA-DCRX (receiver) + LRA-EXTX (chime extender)

The LRA-EXTX must be programmed to a compatible receiver.

All products in the LRA series are compatible with one-another. Systems may be expanded by adding transmitters (push buttons, PIR motion sensors, magnetic door contacts, and outdoor driveway sensors) and /or adding receivers.

BASIC FEATURES:

- Range from transmitter (push button, motions sensor, etc.) is up to 1,000 ft. line of sight. Environmental objects such as metal, concrete, etc., will diminish the range.
- Powered by 3 x C-sized alkaline batteries (not included). Optional plug-in power cord is available.
- Volume control - zero to 90 dB.
- Flashing strobe can be turned on or off. Sound may be turned on or off.
- Variety of sounds and melodies to choose from.
- Pair this receiver with any LRA transmitters.
- Indoor rated only.

THINGS TO KNOW PRIOR TO USE

- Each LRA-DCRX (receiver) can pair with a total of four (4) wireless transmitters
- Once four (4) transmitters have been added to the receiver you cannot add another unless you delete a transmitter from one of the 4 zones.
- There is no limit to the number of receivers you can pair with a transmitter.
- The receiver is powered by c-sized alkaline batteries or by a plug-in transformer (not included).
- The receiver has 3 (three) modes of operation: 1) chime only, 2) chime and strobe, and 3) strobe only. These options are changed using the selector switch on the side of the unit.
- The volume is adjustable using the knob inside the cover of the unit.

Please Note: All AC-powered chimes work off a low-voltage power transformer. For safety we recommend disconnection electrical power from house c h i m e before installation. If you are not comfortable doing this, we recommend hiring an electrician.

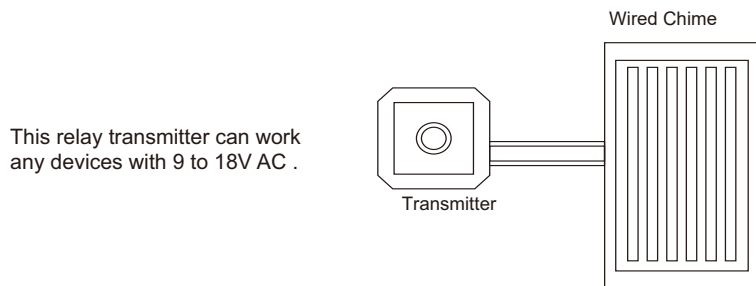

PARTS & FUNCTION

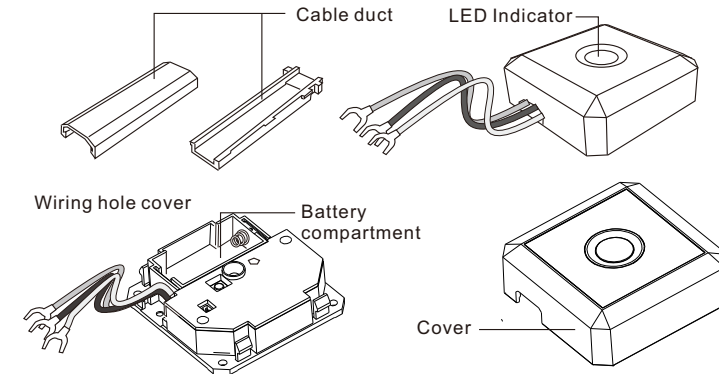
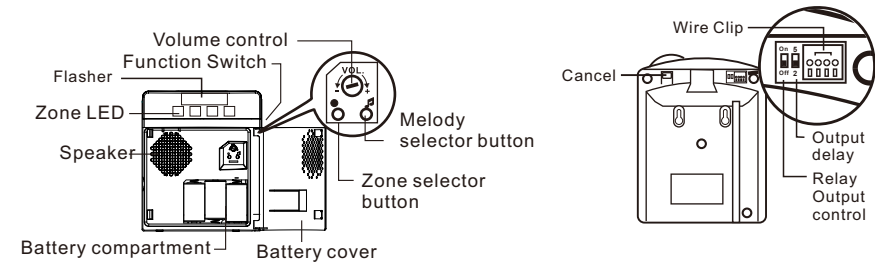

BATTERY INSTALLATION

LRA-DCRX Chime Receiver

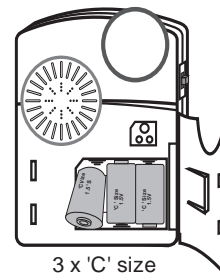

LRA-EXTX Chime Extender

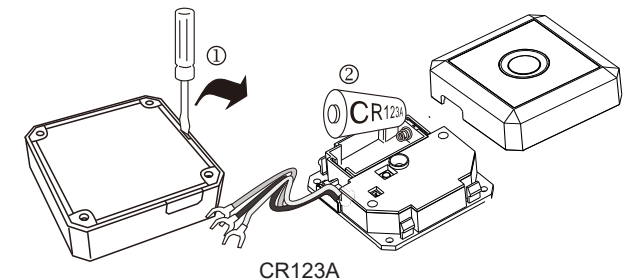

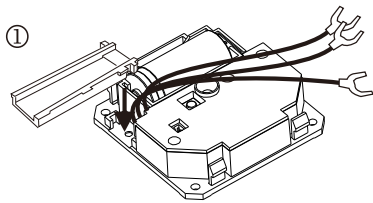

① Insert the cable duct to the base

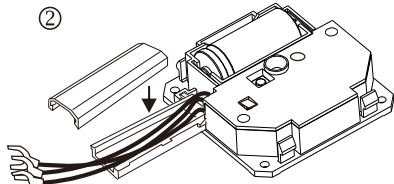

② Place the wires in the cable duct and replace the cable duct cover

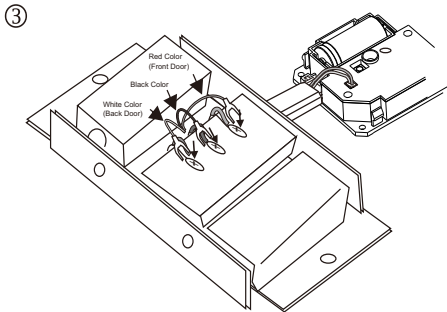

LRA-EXTX WIRE SETUP

- **Red Wire - Front Door on Wired Doorbell**
- **White Wire - Back Door on Wired Doorbell**
- **Black Wire - Common on Wired Doorbell**

Mount the Wireless Chime Extender beside the wired doorbell. Connect the wires as indication (The wiring of doorbells may be different between manufacturers, please refer to the manual).

CODE PAIRING & MELODY SELECTION

- Step 1:** Insert battery to the transmitter to be used.
- Step 2:** Insert batteries to the receiver to be used (chime unit).
- Step 3:** Enter pairing mode for receiver (chime unit). Press and hold the • zone selector button for 3 seconds until the "zone 1" led light is blinking.
- Step 4:** If you are programming zone 1, move to next step. To program to a different zone, scroll to another zone by pressing the • zone selector until you reach the desired zone.

Step 5: Choose the desired melody for the zone by pressing the melody selector 🎵 button until you hear the melody you want to use for that zone.

Step 6: Now that the desired zone & melody are selected, press the "front door" button on the LRA-EXTX transmitter.

Step 7: If your wired doorbell supports a back door button and you would like to program it, repeat **steps 4-6**. For example, scroll to zone 2, select a different melody, and press the "back door" button on the LRA-EXTX to program the back door. **Note:** if you do not have a second door, simply wrap the white wire connector in electrician's tape.

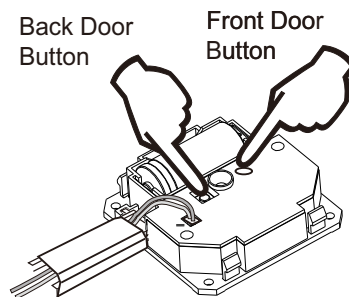

TEST THE TRANSMITTER

To test the transmitter, press the test button of the front door or back door once. the LED indicator will lit and will send a trigger signal to the receiver.

TEST THE CONNECTION

To test the connection between the transmitter and Doorbell, press the Door bell button. the LED indicator on the transmitter will lit and will send a trigger signal to the receiver.

DELETE A TRANSMITTER FROM A ZONE ON RECEIVER

First, Press and hold the 'Zone selector' • button for 3 seconds to enter the programming mode. Press the 'Zone selector' button • to scroll the zone you want to delete. Press and hold both the 'Zone selector' • button and the 'Melody' button 🎵 for approximately 5 seconds. The chime will generate a tone to indicate the remote on this zone has been deleted.

CHANGING THE MEDLODY FOR A ZONE

First, Press and hold the 'Zone selector' button • for 3 seconds to enter programming mode. Press the 'Zone selector' button • to scroll to the zone you want to change. Press the 'Melody' 🎵 button to select the new melody/tone and then push button on the transmitter. You will hear a tone to indicate the melody has been changed.

BATTERY LOW INDICATOR

If a zone LED light is blinking, it indicates that the battery is low for this transmitter. You must replace the battery as soon as possible. If the white flash at the top of the Chime blinks every 5 seconds, this indicates the receiver batteries are low. You must replace the batteries of the receiver .

TECHNICAL SUPPORT

If you need assistance with the operation of this product, please contact us. You can reach us by phone at 904-245-1184 from 8:00AM to 5:00PM Monday through Friday, EST. You may also reach us via email at info@safeguard-supply.com.

WARRANTY INFORMATION

The product you have purchased is guaranteed against defects in workmanship and materials for a period of one year from the date of purchase. Warranties implied by law are subject to the same time period limitation. For a detailed warranty policy, please visit our website by visiting: www.safeguardsupply.com

FCC Statement:

This equipment has been tested and found to comply with the limits for a Class B digital device, pursuant to part 15 of the FCC Rules. These limits are designed to provide reasonable protection against harmful interference in a residential installation. This equipment generates, uses and can radiate radio frequency energy and, if not installed and used in accordance with the instructions, may cause harmful interference to radio communications.

However, there is no guarantee that interference will not occur in a particular installation. If this equipment does cause harmful interference to radio or television reception, which can be determined by turning the equipment off and on, the user is encouraged to try to correct the interference by one or more of the following measures:

- * Reorient or relocate the receiving antenna.
- * Increase the separation between the equipment and receiver.
- * Connect the equipment to an outlet on a circuit different from that to which the receiver is connected.

This device complies with part 15 of the FCC rules. Operation is subject to the following two conditions: (1) This device may not cause harmful interference, and (2) this device must accept any interference received, including interference that may cause undesired operation.

Note: Modifications to this product will void the user's authority to operate this equipment.



WARNING: Cancer and Reproductive Harm. Go to www.P65Warnings.ca.gov for more information.